

**FLOOD MAP**

Intended User **Reverand Paul Begeron**  
 Property Address **182 St. Peters Road**  
 City **Washington** County **St. Landry** State **LA** Zip Code **70589-4198**  
 Client **Reverand C. Paul Begeron**

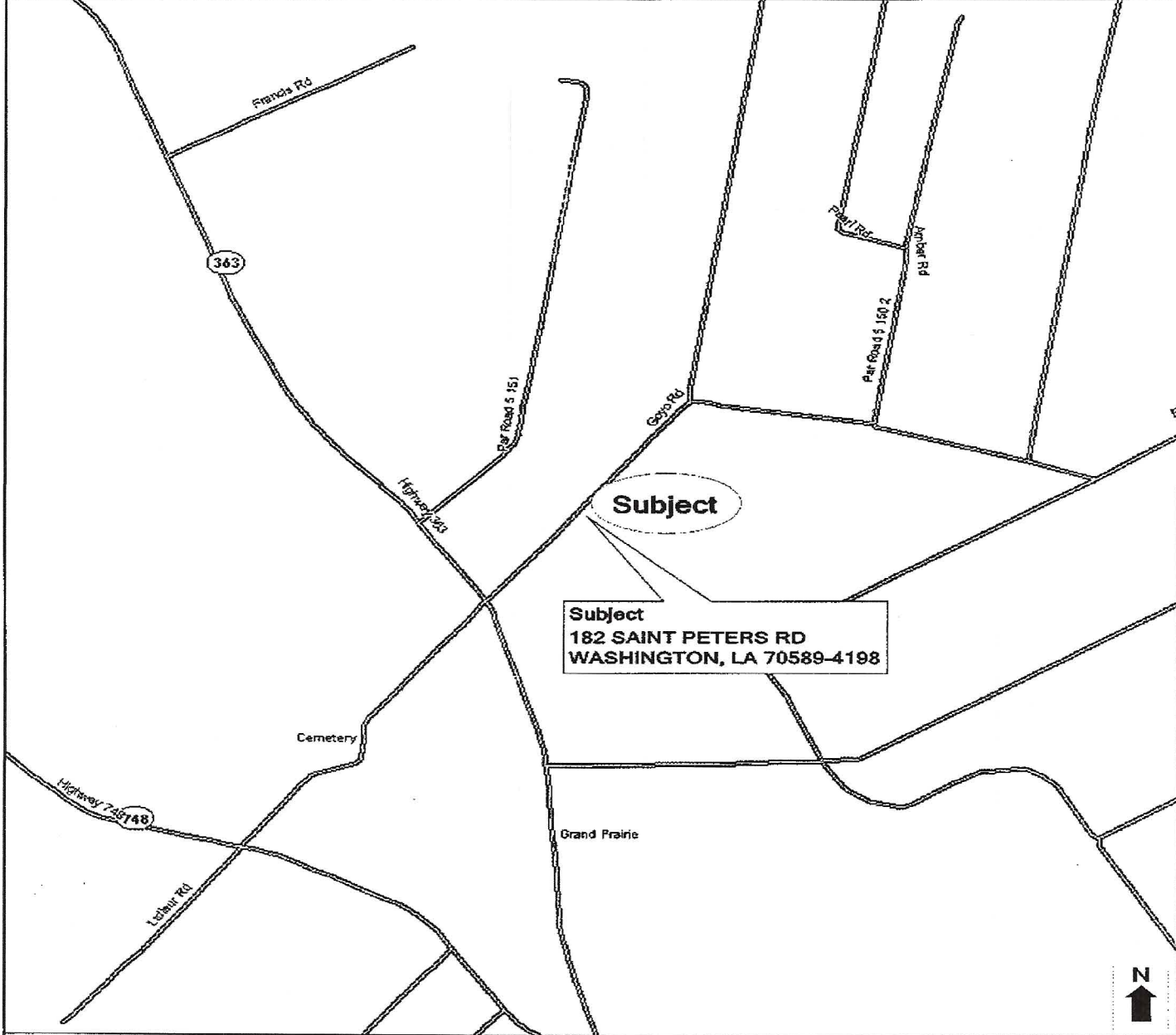

**Flood Zones**

- |   |  |
|---|--|
| Areas inundated by 500-year flooding                      | Floodway areas                                   |
| Areas outside of the 100- and 500-year flood plains       | Floodway areas with velocity hazard              |
| Areas inundated by 100-year flooding                      | Areas of undetermined but possible flood hazards |
| Areas inundated by 100-year flooding with velocity hazard | Areas not mapped on any published FIRM           |

**Flood Zone Determination**

Latitude: **30.692566328626**  
 Longitude: **-92.14652900837**  
 Community Name:  
**UNINCORPORATED AREA**  
 Community: **220165**  
 SFHA (Flood Zone): **Out**  
 Within 250 ft. of multiple flood zones: **No**  
 Zone: **X**  
 Panel: **0125D** Panel Date: **2010-08-05**  
 FIPS Code: **22097** Census Tract: **9602**

This Report is for the sole benefit of the Customer that ordered and paid for the Report and is based on the property information provided by that Customer. That Customer's use of this Report is subject to the terms agreed to by that Customer when accessing this product. No third party is authorized to use or rely on this Report for any purpose. NEITHER FIRST AMERICAN FLOOD DATA SERVICES NOR THE SELLER OF THIS REPORT MAKES ANY REPRESENTATIONS OR WARRANTIES TO ANY PARTY CONCERNING THE CONTENT, ACCURACY OR COMPLETENESS OF THIS REPORT, INCLUDING ANY WARRANTY OF MERCHANTABILITY OR FITNESS FOR A PARTICULAR PURPOSE. Neither FARES nor the seller of this Report shall have any liability to any third party for any use or misuse of this Report.